

## GIR50-DO-2RS

### Rod end

Schaeffler ID:  
0066356440000

Rod end with internal thread, right hand thread, requiring maintenance, sliding contact surface: steel/steel, DIN ISO 12240-4, dimension series E, type F, sealed

### Technical information

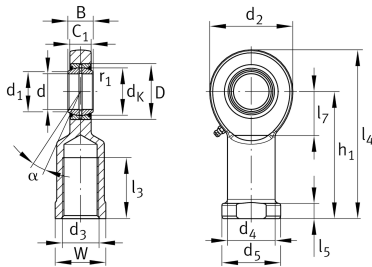

### Main Dimensions & Performance Data

d	50 mm	Bore diameter bearing
D	75 mm	Outside diameter bearing
B	35 mm	Width inner ring
$C_r$	157,000 N	Basic dynamic load rating, radial
$C_{0r}$	314,000 N	Basic static load rating, radial
$G_r$	0,043 - 0,12 mm	Radial Clearance
	3.532 kg	Weight

### Dimensions

$d_K$	66 mm	Ball diameter
$d_1$	55.9 mm	Outer flange diameter inner ring
$d_2$	112 mm	Outer eye diameter
$d_3$	M45x3	Thread size
$d_4$	62 mm	Shank diameter
$h_1$	160 mm	Shank Length Internal thread head
$\alpha$	6 °	Tilt angle
$l_3$	68 mm	Thread length Internal thread
$l_4$	216 mm	Total length internal thread head
$l_5$	20 mm	length rod end shank
$l_7$	60 mm	Distance drilling with/shaft start
$d_5$	75 mm	Shank diameter, large
$C_1$	30 mm	Width of the rod end
$r_{1smin}$	0.6 mm	Edge Spacing
W	65 mm	Width Across Flat
$d_{OT}$	0 mm	Bore diameter bearing, upper tolerance
$d_{UT}$	-0.012 mm	Bore diameter bearing, lower tolerance
$B_{OT}$	0 mm	Width inner ring, upper tolerance
$B_{UT}$	-0.12 mm	Width inner ring, lower tolerance

**Temperature range**

T <sub>min</sub>	-30 °C	Operating temperature min.
T <sub>max</sub>	130 °C	Operating temperature max.